



CP PUMP

Applications:

- Cutting, turning, milling, boring, grinding and similar applications of the machine tools,
- Band sawing machines,
- Circulation systems. CP Pumps are used for pumping of cutting / cooling fluids.

Fluid Specifications:

- Coolants,
- Cutting oils,
- Grinding oils,
- Water,
- Chip contains liquids (max. 6mm)
- Fluid temperature 0...60 °C
- Kinematic viscosity 1...90 mm²/s

Materials:

Pump body	: Cast iron - DIN GG 25
Volute	: PP
	Cast iron - DIN GG 25 (Optional only for CP1 series)
Impeller	: PP
	Brass (Optional only for CP1 series)
Pump shaft	: Engineering steel - AISI 1040 (DIN C35)
	Stainless steel- AISI 420(DIN X20Cr13) (Optional)
Electric motor	: 3 phase induction motor
	1 phase induction motor (Optional)
	2 pole
	Protection degree IP 54

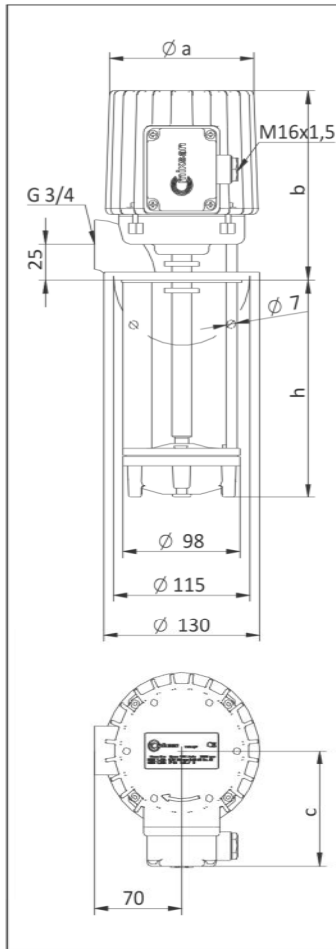

DIMENSIONS & NOMINAL VALUES

TYPE	Depth of immersion h (mm)	mm			Weight kg	Power kW	Voltage V(Δ/Y)	Frequency Hz	Rated current A	Speed rpm
		a	b	c						
CP 112	130	127	158	95	6.6	0.25	230/400	50	1.26/0.73	2760
CP 117	180				7.1					
CP 122	230				7.4					
CP 127	280				7.9					
CP 135	350				8.4					
CP 212	130	127	158	95	6.6	0.25	230/400	50	1.26/0.73	2760
CP 217	180				7.1					
CP 222	230				7.4					
CP 227	280				7.9					
CP 235	350				8.4					

- * Pump dimensions according to EN 12157.
- ** The performance curves are based on $1 \text{ mm}^2/\text{s}$ (cSt) kinematic viscosity values and $997 \text{ kg}/\text{m}^3$ density
- *** Curve tolerance according to ISO 9906:2012 Grade 3B .

